

VII

DIP Switch Series

ETC7-DM Tri-state DIP Switch Through Hole type 2.54mm pitch

Specifications

Contact Rating:	25 mA at 24VDC (switching) 100 mA at 50VDC (steady state)
Life:	2,000 cycles
Contact Resistance:	100mΩ Max.
Insulation Resistance:	100MΩ at 100VDC Min
Dielectric Strength:	300VAC Min

Materials

Base & Cover: PPS (UL94V-0)
 Actuator: PA46 (UL94V-0).
 Contacts: Brass, Gold /Tin Plate
 Terminals: Brass, Gold /Tin Plate

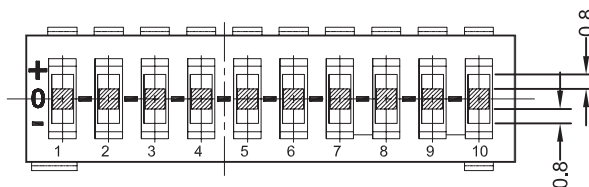
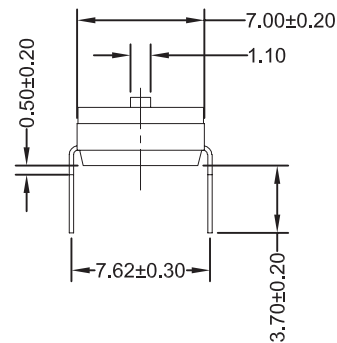
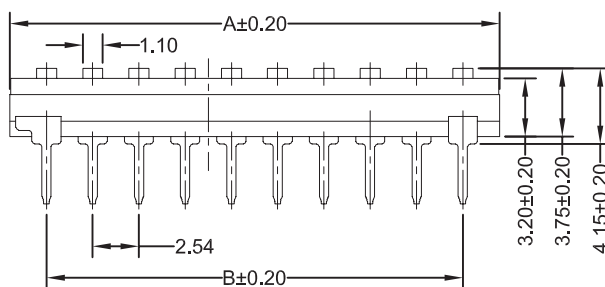

POS.	DIMENSIONS	
	A	B
4P	11.64	7.62
5P	14.18	10.16
8P	21.80	17.78
9P	24.34	20.32
10P	26.88	22.86

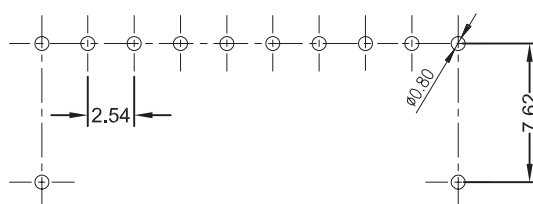

RECOMMENDED P.C.B. LAYOUT (TOP VIEW)

[SCHEMATIC]

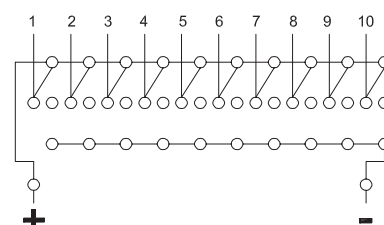

ORDER INFORMATION

ETC7-DM - XX - N - 0 0

Part Number _____ Packaging: 0=Tube
DM :Tri-state Dip Switch _____ 0:Non-sealed
Through Type _____
Number of Pos.: 04~10 Pos. _____ Color: N=Black